

# Use of POCT Flu equipment for patients with suspected coronavirus (COVID-19)

## Roche Liat Flu Analysers

Analysis of samples from patients with suspected coronavirus (COVID-19) on the **Roche Liat** flu analyser is acceptable, providing the following precautions are taken:

PPE **MUST** be worn: gloves, apron and surgical mask

1. To ensure no bubbles, press the pipette bulb down fully **before** placing into the transport medium. Insert tip below the surface of the liquid. **Slowly** release the pipette bulb to collect sample.
2. Insert the pipette into the tube sample compartment of the test cassette and **gently squeeze** the bulb to empty pipette. Do not puncture the seal below the compartment. Keep bulb of pipette depressed after emptying until discarded into sharps bin.

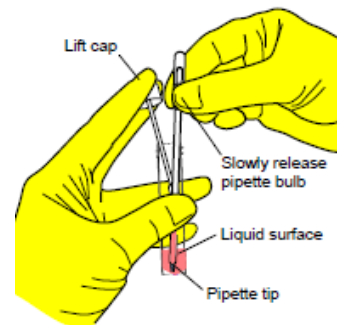

3. Re-cap the test cassette firmly. Re-cap the patient swab sample save until results are reported and then discard in a clinical waste bin.
4. **Wipe the cap of the test cassette with a 70% isopropanol wipe.**
5. Select “scan” and scan the test cassette barcode. The tube entry door will open automatically.

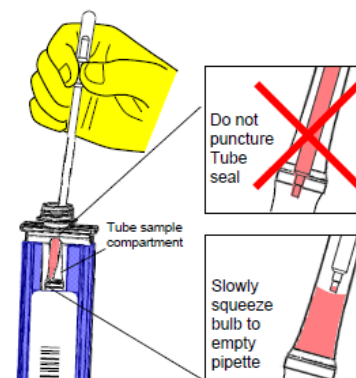

6. Remove the test cassette from the sleeve and insert it into the analyser until the tube clicks into place.
7. **Wipe down the bench space where the pipetting took place (i.e. where the test cassette and swab media tube were placed) using 70% isopropanol wipes**
8. When the test is complete the tube entry door will open. When prompted, remove the tube and discard in a clinical waste bin.
9. **Clean the exterior of the analyser and front buttons using 70% isopropanol wipes**
  - Spillage onto work surfaces **MUST** be cleaned up immediately with a 70% isopropanol wipe.

If you have any further questions, please contact Point of Care Testing:

LGI Ext: 22338

SJUH Ext: 64791

Email: [leedsth-tr.pointofcare@nhs.net](mailto:leedsth-tr.pointofcare@nhs.net)